

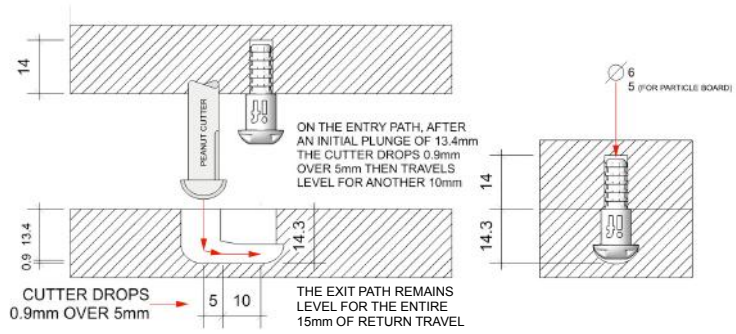

## Machining

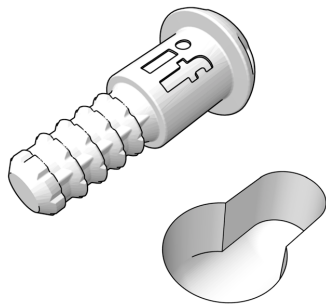

## Assembly

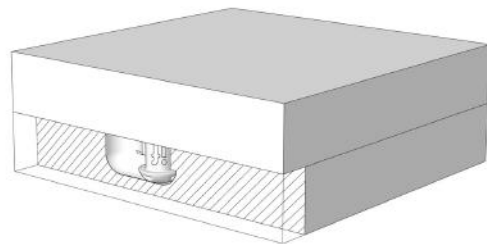
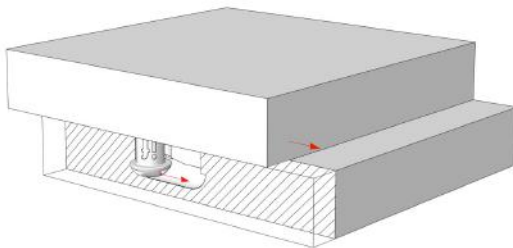
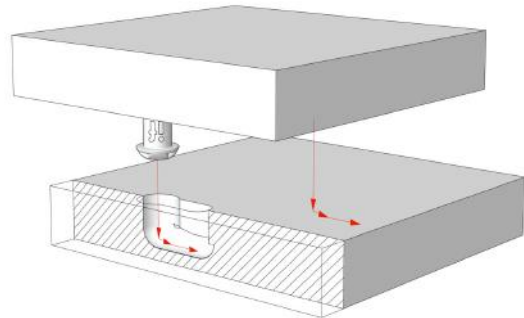
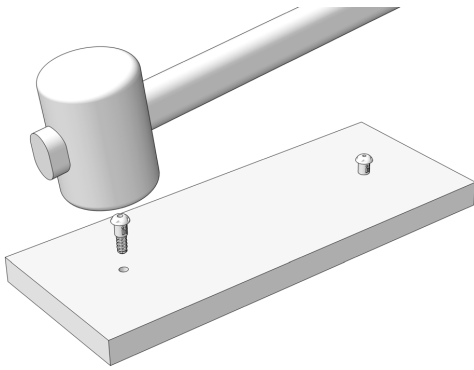

## Applications

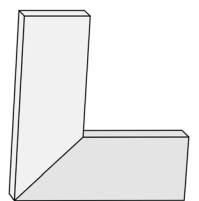
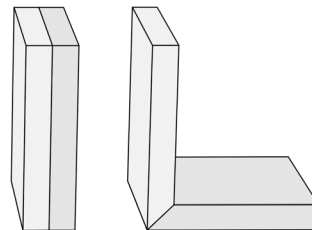
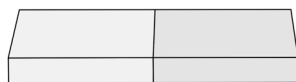
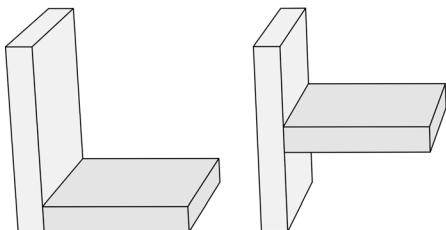



**Technical Specifications**

**PEANUT® 3** Technical data

<b>COMPONENT COMPOSITION</b>	GLASS-FIBRE REINFORCED PLAST
<b>MATERIAL THICKNESS</b>	90°: >15.3MM / 45°: >18mm
<b>TOLERANCE (PEANUT® CUTTER SLOT)</b>	+0.3mm and -0.4mm (DEPTH)

**Strength Data**

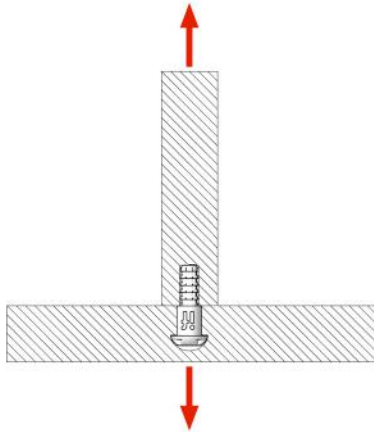

Fig. A

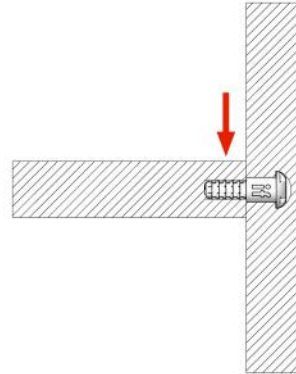

Fig. B

**JOINT TYPE: 90° JOINT**

**PEANUT® 3** Tensile strength (based on 1 component): TESTED BY:



MATERIAL	TENSILE STRENGTH (Fig. A)
PARTICLE BOARD (18mm MFC) from EGGER	900 N / 90 KG ( 1 COMPONENT )
MDF (18mm)	1050 N / 105 KG ( 1 COMPONENT )

PLEASE NOTE THAT THE STRENGTH MAY VARY DEPENDING ON MATERIAL AND QUALITY OF MATERIAL USED.

**JOINT TYPE: 45° MITRE JOINT**

**PEANUT® 3** Tensile strength (based on 1 component): TESTED BY:



MATERIAL	TENSILE STRENGTH (Fig. A)
PARTICLE BOARD (18mm MFC) from EGGER	600 N / 60 KG ( 1 COMPONENT )
MDF (18mm)	670 N / 67KG ( 1 COMPONENT )

PLEASE NOTE THAT THE STRENGTH MAY VARY DEPENDING ON MATERIAL AND QUALITY OF MATERIAL USED.

**JOINT TYPE: 90° JOINT**

**PEANUT® 3** Shear strength (based on 1 component): TESTED BY:



MATERIAL	SHEAR STRENGTH (Fig. B)
PARTICLE BOARD (18mm MFC) from EGGER	650 N / 65 KG ( 1 COMPONENTS )
MDF (18mm)	920 N / 92 KG ( 1 COMPONENTS )

PLEASE NOTE THAT THE STRENGTH MAY VARY DEPENDING ON MATERIAL AND QUALITY OF MATERIAL USED.